

#### 1. Product Name

2X Drip Edge T-Bar – Concrete Balcony Edge Stop

#### 2. Manufacturer

Formulated Materials, LLC  
3010 NW 149th St., SUITE 100  
Oklahoma City, OK 73134  
Tech Services : (844) 405-3676  
[www.formulatedmaterials.com](http://www.formulatedmaterials.com)  
[www.formulated.info](http://www.formulated.info)

#### 3. Product Description

The new 2X Drip Edge T-Bar is a premium 6063 aluminum balcony pour stop engineered with a secondary drip edge to drive moisture away from the bar's face. This protects the finish from alkaline water exposure, reducing staining and long-term discoloration.

##### Key Features

- New secondary drip edge for water control
- Protects finish from staining and discoloration
- Compatible with Elevation® Waterproofing System
- Available in clear, bronze, and black anodized finishes
- Prime coat available
- Custom powder coat available
- Backed by a full system warranty when installed by licensed dealers

##### Where to Use

- Multifamily balconies
- Commercial or mixed-use concrete decks
- Exposed edge conditions where appearance during construction is important

##### Product Composition

- Material: 6063 Aluminum Alloy
- Finish: Anodized (Clear, Bronze, Black, Prime Coat, or Custom Powder Coat)
- Temper: T5

##### Product Limitations

- Designed for use with Elevation Waterproofing Systems
- Must be installed per Formulated Materials guidelines
- Not intended as a standalone waterproofing component

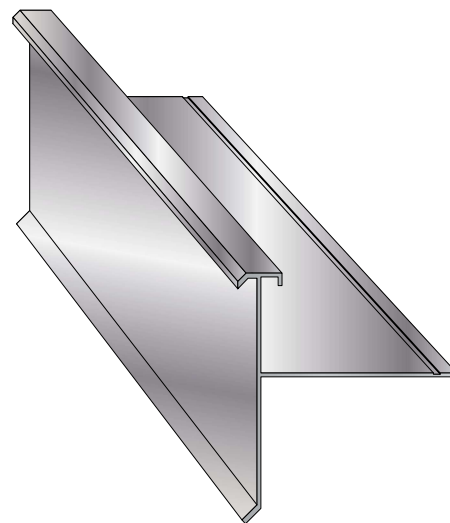

#### 4. Technical Data

##### Technical Chart

Property	Value
Material	6063 Aluminum
Thickness	0.058" (1.47mm)
Nail Flange	3.000" (76.2mm)
Temper	T5
Tensile Strength (min)	17 ksi

#### 5. Instructions

##### General Surface Prep

Ensure the surface is clean, dry, and structurally sound. Repair any cracks, spalling, or unstable areas. Remove dust, dirt, oil, grease, and contaminants. Use mechanical methods (grinding, sanding) if needed. Verify moisture levels meet product requirements. Address excessive moisture if necessary. Apply primer as specified and allow it to dry thoroughly. Maintain recommended temperature and humidity. Avoid extreme conditions. Perform a final check to clear debris and confirm the surface meets all preparation guidelines before application.

##### Installation of Product

Always read the Safety Data Sheet (SDS) for full precautionary instructions before use.

##### Tools Required:

- Tape Measure
- Snips or Angle Grinder
- Hammer
- 1.5" – 2.0" Roofing Nails

### Application

- The T-Bar is installed after the installation of the waterproofing system
- Measure and Cut:
  - Measure the distance along the balcony face between the mounting plates of the TTPs and cut the T-Bar accordingly.
  - T-Bar should extend over the T-Bar Termination Pocket base plate and into the trough to ensure proper shingling and drainage are maintained.
  - Material can be cut with angle grinder (using appropriate grinding wheel) or heavy duty metal shears. Proper PPE should be used at all times when cutting or shaping.
- Address Exterior Corners (if applicable):
  - Measure from each TTP to the corner and add 2" to your total length.
  - Mark the corner location, adding 1" from the desired corner.
  - Cut a "V" into the nailer flange of the T-Bar and notch the top flange.
  - Snip the kick-out on the bottom-front-face of the T-Bar for relief when folding at 90.
  - Fold the metal at the corner with moderate pressure and trim the ends for proper alignment.
- Add Spacer Shims:
  - Place Elevation® Spacer Shims every 14" along the bottom of the T-Bar that rests on the deck to create consistent spacing for the weep system.
  - Overhang T-Bar by 1/4" to identify where to drive fasteners.
  - Also run spacer shim down the back-side of the down-leg of the T-Bar to continue the weep system.
- Fasten the T-Bar:
  - Position the T-Bar over the Spacer Shims, ensuring the weep gap remains unobstructed.
  - Nail the T-Bar to the deck through the shims, securing stability.
  - Apply a dab of Elevation SM2 Lap Sealant over nail heads to reinforce waterproofing.

Go to [www.formulatedmaterials.com](http://www.formulatedmaterials.com) and [formulated.info](http://formulated.info) for more detailed installation information.

### Storage & Protection

- This product is temperature stable and weather resistant.
- Care should be taken when handling, particularly full bundles, to avoid bending or crushing exposed edges

### Health Precautions

- Follow all local safety regulations, including OSHA Section V: Chapter 4 for Fall Protection in Construction
- Always review the full label and Safety Data Sheet (SDS) for detailed precautionary instructions before use.

### Conformance to Building Codes

Installation must comply with all applicable local, state, and federal codes, regulations, and industry standards.

### 6. Availability

2X Drip Edge T-Bar - Mill Finish	
1.5" Mill Fin. 10'	10347-10
2.0" Mill Fin. 10'	10348-10
2.5" Mill Fin. 10'	10349-10
3.0" Mill Fin. 10'	10350-10
2X Drip Edge T-Bar - Clear Anodized	
1.5" Clear Anod. 10'	10351-10
2.0" Clear Anod. 10'	10352-10
2.5" Clear Anod. 10'	10353-10
3.0" Clear Anod. 10'	10354-10
2X Drip Edge T-Bar - Bronze Anodized	
1.5" Bronze Anod. 10'	10355-10
2.0" Bronze Anod. 10'	10356-10
2.5" Bronze Anod. 10'	10357-10
3.0" Bronze Anod. 10'	10358-10
2X Drip Edge T-Bar - Black Anodized	
1.5" Black Anod. 10'	10359-10
2.0" Black Anod. 10'	10360-10
2.5" Black Anod. 10'	10361-10
3.0" Black Anod. 10'	10362-10
2X Drip Edge T-Bar - Prime Coat	
1.5" Prime Coat 10'	10363-10
2.0" Prime Coat 10'	10364-10
2.5" Prime Coat 10'	10365-10
3.0" Prime Coat 10'	10366-10
2X Drip Edge T-Bar - Powder Coat (Custom)	
1.5" Powder Coat (Custom) 10'	10367-10
2.0" Powder Coat (Custom) 10'	10368-10
2.5" Powder Coat (Custom) 10'	10369-10
3.0" Powder Coat (Custom) 10'	10370-10

### 7. Product Warranty

For details and complete warranty information, visit [www.formulatedmaterials.com](http://www.formulatedmaterials.com).

### 8. Product Maintenance

Properly installed products do not require ongoing maintenance.

**9. Technical Services Information**

For Technical Services, contact Formulated Materials at (844) 405-3676.

**10. Filing System**

Additional product information is available from Formulated Materials upon request.



Formulated Materials, LLC  
3010 NW 149th St., SUITE 100  
Oklahoma City, OK 73134  
Tech Services : (844) 405-3676  
[www.formulatedmaterials.com](http://www.formulatedmaterials.com)  
[www.formulated.info](http://www.formulated.info)