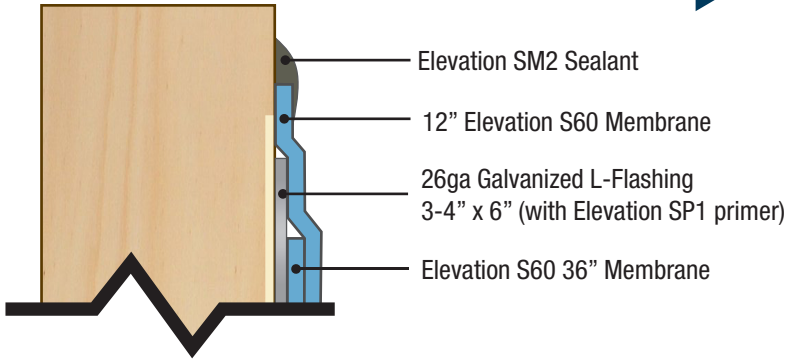
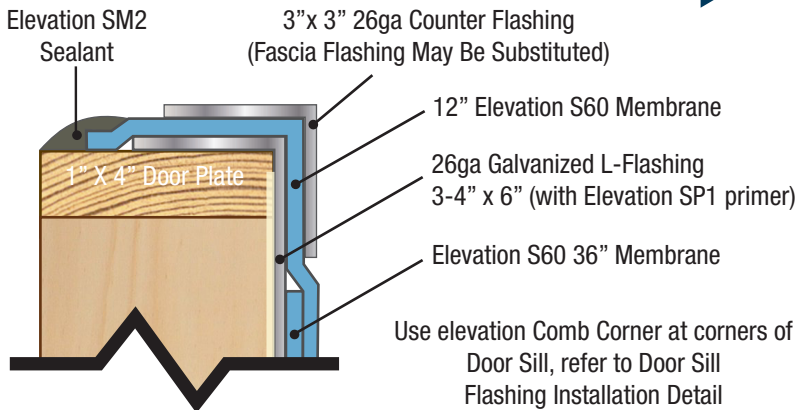

TYPICAL BALCONY EDGE DETAIL
PERIMETER WALL DETAIL

Note: This system, along with the application of the exterior concrete, is designed specifically to be installed prior to lath and stucco, siding, door and slider frames or thresholds, etc.. Building wrap is to be in place to where pockets, flashings or membranes can extend over the wrap that is at or below deck level. Bldg. wrap that is above deck level is to be installed over the top of all system components. Any deck design or configuration at or around columns, walls, fascia edges, fascia corners, etc., that require cutting or trimming of any flashing or balcony edge metals will compromise the effectiveness of this system.

BALCONY ENTRY/BREEZEWAY DETAIL

Date: _____ Approved / Disapproved

Comments: _____

